

POWER AMPLIFIER

KAC-6202

SERVICE MANUAL

KENWOOD

Kenwood Corporation

© 2005-5 PRINTED IN JAPAN
B53-0286-00 (N) 1708

KAC-6202 (E type, M type)

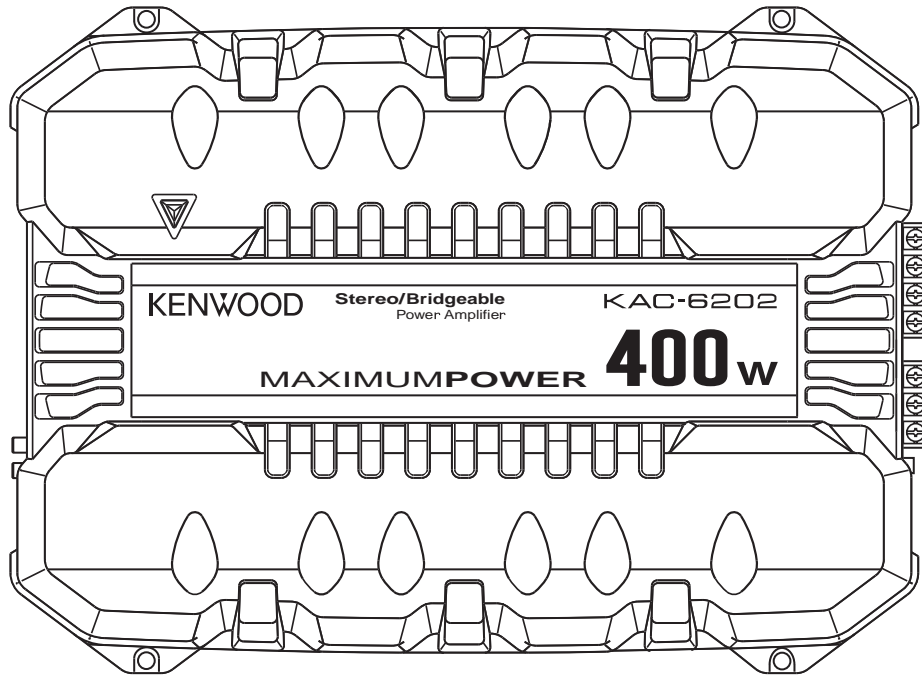

KAC-6202 (K type)

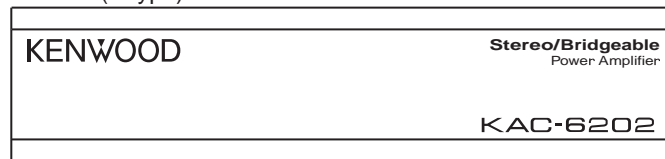

Connecting cord assy (E30-6145-05)

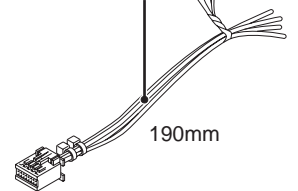

Accessory (W01-1607-05)

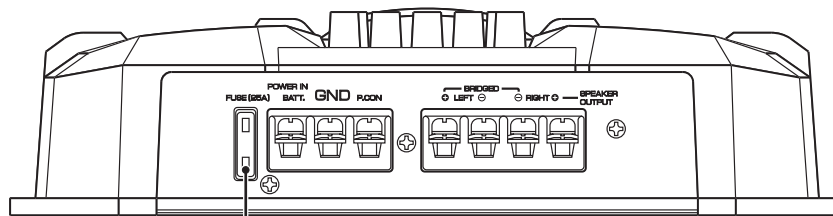
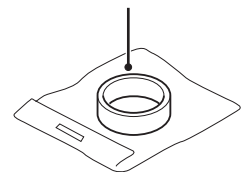

Fuse (F52-0014-05)

Screw set (N99-1587-05)

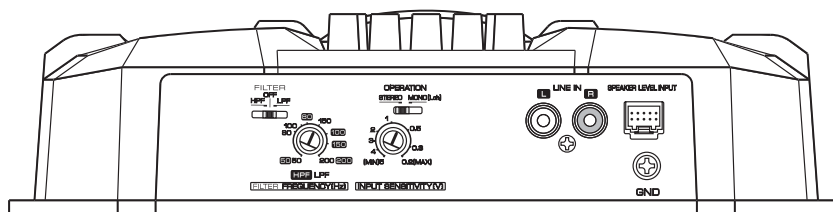
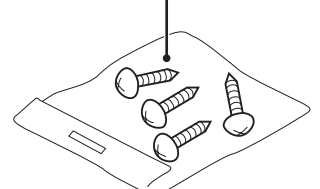

This product uses Lead Free solder.

BLOCK DIAGRAM

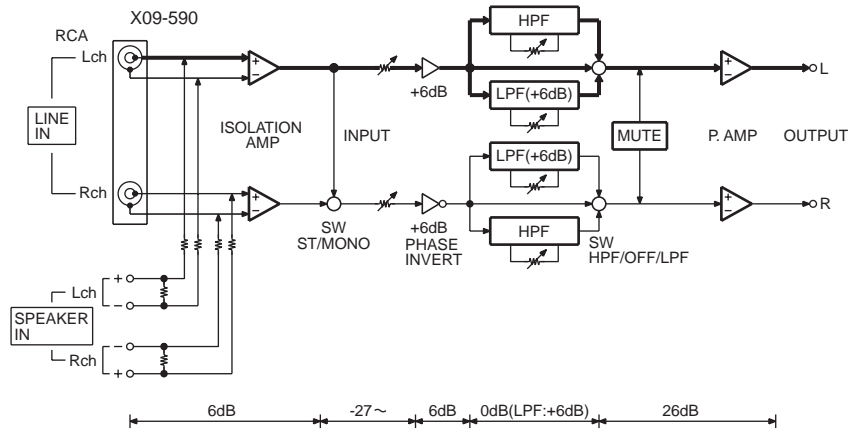

COMPONENTS DESCRIPTION

● AUDIO UNIT (X09-5900-10)

Ref. No.	Application / Function	Operation / Condition / Compatibility
IC1	Buffer amplifier	+6dB, low-impedance conversion
IC2	Isolation amplifier	Common mode noise filtering
IC3	Buffer amplifier	+6dB, Rch reversal
IC4	Reversal buffer amplifier	+6dB, reversal amplifier
IC5,6	HPF/LPF	Fitter with variable cutoff
IC7	DC/DC converter	Oscillation and control of DC/DC converter
Q1,2	Switching	Transistor for ON/OFF control of latter step driver
Q3~6	Drive transistor	FET driver for the latter steps
Q7,8	Switching FET	Switching FET for the secondary power supply
Q201,202	For muting	Transistor for muting B-class step
Q203~206	Differential amplifying transistor	Transistor for first step differentiation amplification
Q207~210	Differential amplifying transistor	Transistor for second step differentiation amplification
Q211,212	Current mirror load	Current mirror load of second step differentiation
Q213,214	Temperature compensating transistor	For prevention of thermal-runaway of the final transistor
Q215~218	Over current protection	Transistor protection against excess current
Q219~222	Power amplification	First step of Darlington power amplification
Q223~226	Power amplification	Second step of Darlington power amplification
Q501,502	Constant voltage stabilization	Transistor for constant voltage stabilization
Q601,602	Switching	Transistor for mute ON/OFF control for B-class step
Q603,604	Switching	Transistor for mute control for B-class step
Q605	Switching	Transistor for DC protection circuit latch
Q606	Switching	For DC protection latch ON control
Q607,608	Drive transistor	For DC protection circuit driving

COMPONENTS DESCRIPTION

Ref. No.	Application / Function	Operation / Condition / Compatibility
Q609	Switching	For PULL-DOWN of DC/DC converter 2 pin
Q610~614	Switching	Transistor for power supply circuit ON/OFF control
Q615	Switching	Transistor for mute ON/OFF control for latter steps
D1	Circuit protection diode	For circuit protection at reverse connection of power supply cord
D4~7	Switching	Backflow prevention diode
D8,9	Rectifying diode	Rectification on the secondary power supply side
D101~103	Static protection diode	For circuit protection against static
D201	Switching	Backflow prevention diode
D202,203	Operation stabilizer diode	Contains thermal fluctuation of transistor Vbe of second step differentiation
D204,205	Current mirror load	Current mirror circuit load
D206~211	Switching	Backflow prevention diode
D501	Indicator LED	Indicator for behavior visual check
D601	Bias diode	Backflow prevention diode
D602,606	Switching	Backflow prevention diode
D603	Level shifter	For DC protection circuit bias
D604	Switching	For turning operation off at P-CON momentary power down
D605	Switching	For turning off operation at BATT excess voltage and for circuit protection
D607	Level shifter	For bias of the mute control circuit
D608~612	Switching	Backflow prevention diode

ADJUSTMENT

No.	Item	Alignment point	Method	Align for	Note
1	IDLE CURRENT	VR3 (Lch) VR4 (Rch)	Connect a DC voltmeter between emitter resistor	2.5mV	After Power on 5 minutes

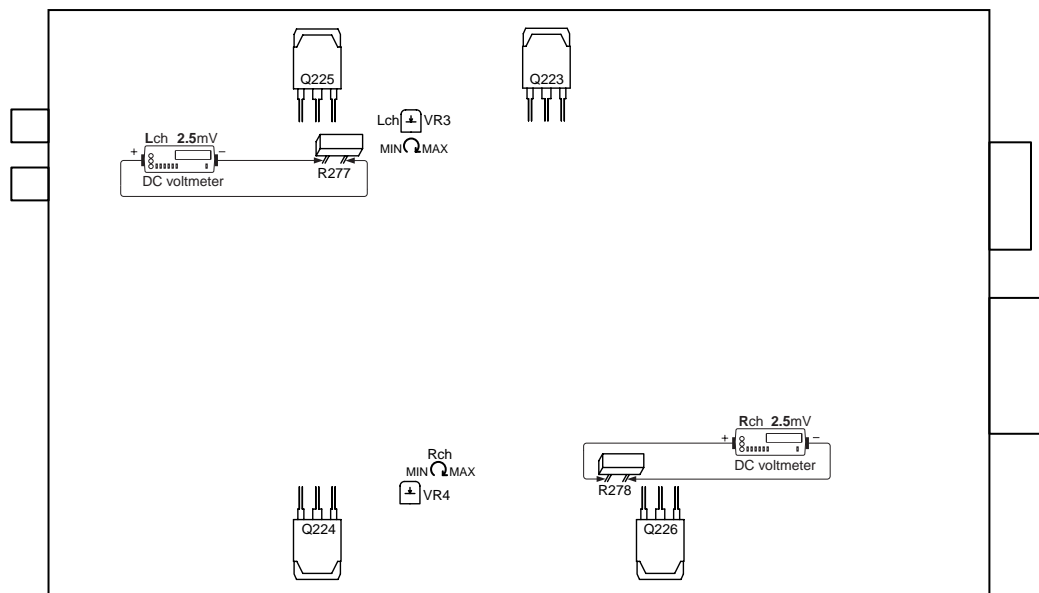

KAC-6202 PC BOARD (FOIL SIDE VIEW)

AUDIO UNIT
X09-5900-10
(J76-0088-11)

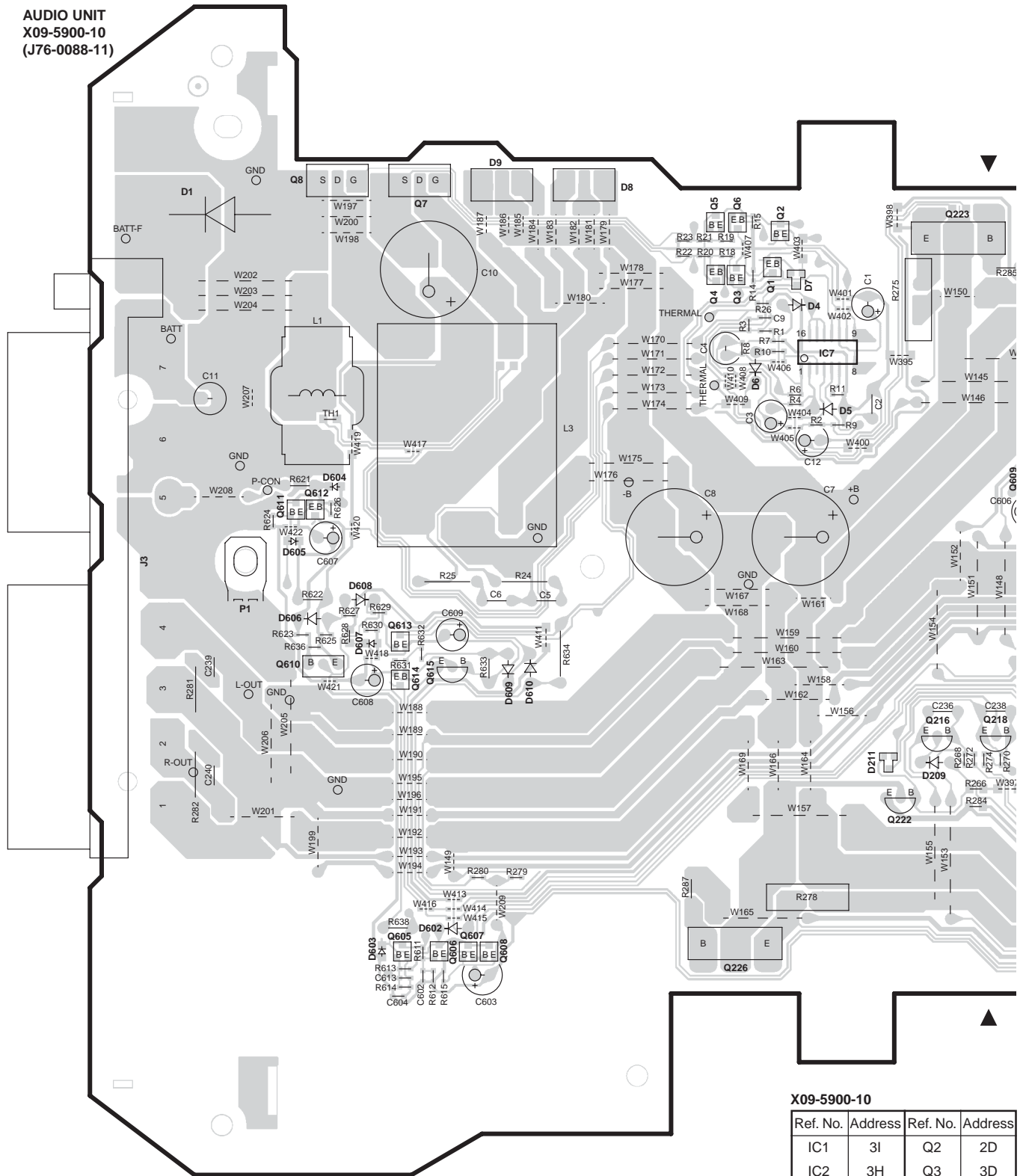

X09-5900-10

Ref. No.	Address	Ref. No.	Address
IC1	3I	Q2	2D
IC2	3H	Q3	3D
IC3	4I	Q4	3D
IC4	4I	Q5	2D
IC5	5H	Q6	2D
IC6	5I	Q7	2C
IC7	3E	Q8	2B
Q1	2D	Q201	4H

Refer to the schematic diagram for the values of resistors and capacitors.

KAC-6202

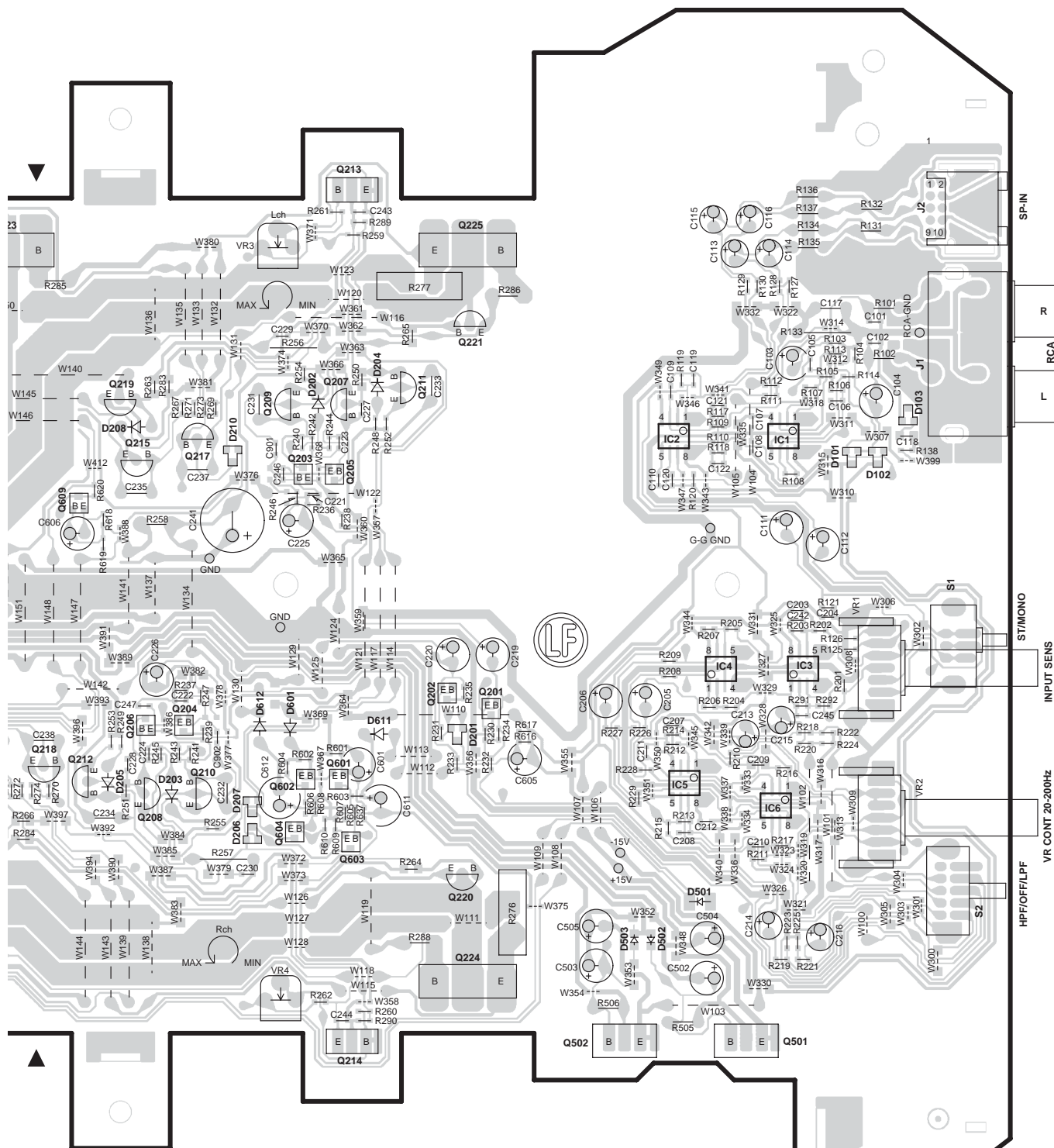

Ref. No.	Address	Ref. No.	Address	Ref. No.	Address	Ref. No.	Address	Ref. No.	Address	Ref. No.	Address
Q202	4G	Q209	3G	Q216	4E	Q223	2E	Q602	5G	Q609	3F
Q203	3G	Q210	5F	Q217	3F	Q224	5H	Q603	5G	Q610	4B
Q204	4F	Q211	3G	Q218	4F	Q225	2H	Q604	5G	Q611	3B
Q205	3G	Q212	4F	Q219	3F	Q226	6D	Q605	5C	Q612	3B
Q206	4F	Q213	2G	Q220	5G	Q501	6I	Q606	5C	Q613	4C
Q207	3G	Q214	6G	Q221	3H	Q502	6H	Q607	5C	Q614	4C
Q208	5F	Q215	3F	Q222	5E	Q601	5G	Q608	5C	Q615	4C

KAC-6202

IC1-6 : RC45801DR	D1 : RM4ZLF-J4NF	Q1,2 : DTA114EUA	Q211,212,217,218
IC7 : TL4941DR	D4-6,202-205,208,209, 601,602,606,608-612	Q3,6 : 2SC4097	: 2SA992-A(F,E)
	: 1SS133	Q4,5 : 2SA1577	Q213,214 : 2SC3419(Y)-F
	D7,102,206 : LM1MA142WK-G	Q7,8 : 2SK3662-F	Q219,220 : 2SC1627A-F
	D8 : FCH10A20	Q201,202,601,603, 606-609,611-613	Q221,222 : 2SA817A-F
	D9 : FRH10A20	: 2SC4081	Q223,224 : 2SC3856NF
	D101,201,207,210,211	Q203-206,602,604,605, 614 : 2SA1576A(R,S)	Q225,226 : 2SA1492NF
	D103 : LM1MA142WA-G	Q207-210,215,216,615	Q501 : 2SD2012-F
	D501 : UMZ6.8N	: 2SC1845-A(F,E)	Q502 : 2SB1375-F
	D502,503 : 02DZ16F-Y		Q610 : 2SB1241
	D603,607 : 02DZ10F-Y		
	D604 : 02DZ6.8F-Y		
	D605 : 02DZ15F-Y		

——— SIGNAL LINE
 ——— GND LINE
 ——— +B LINE
 ——— -B LINE

(X09-5900-10)

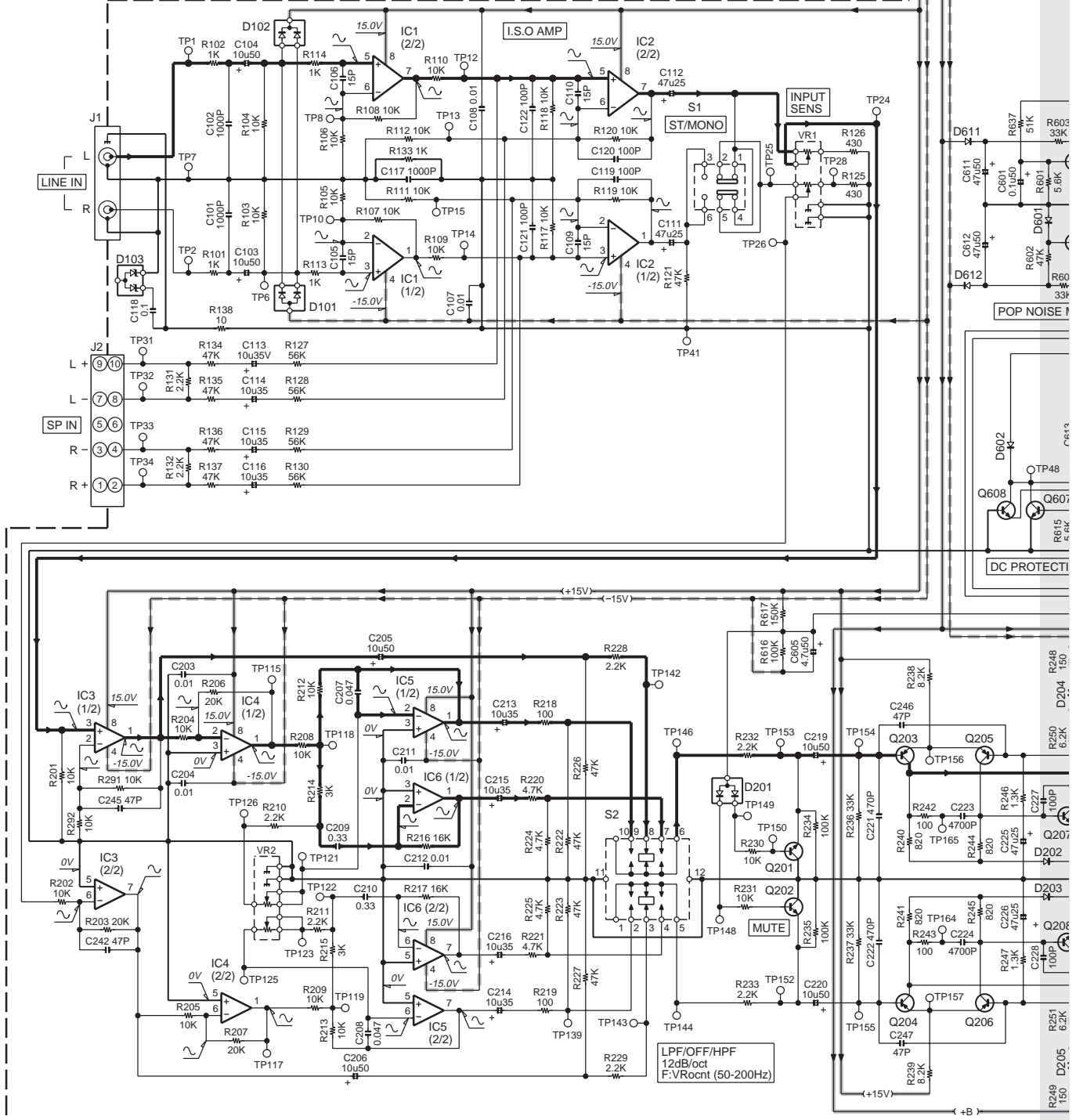

KAC-6202

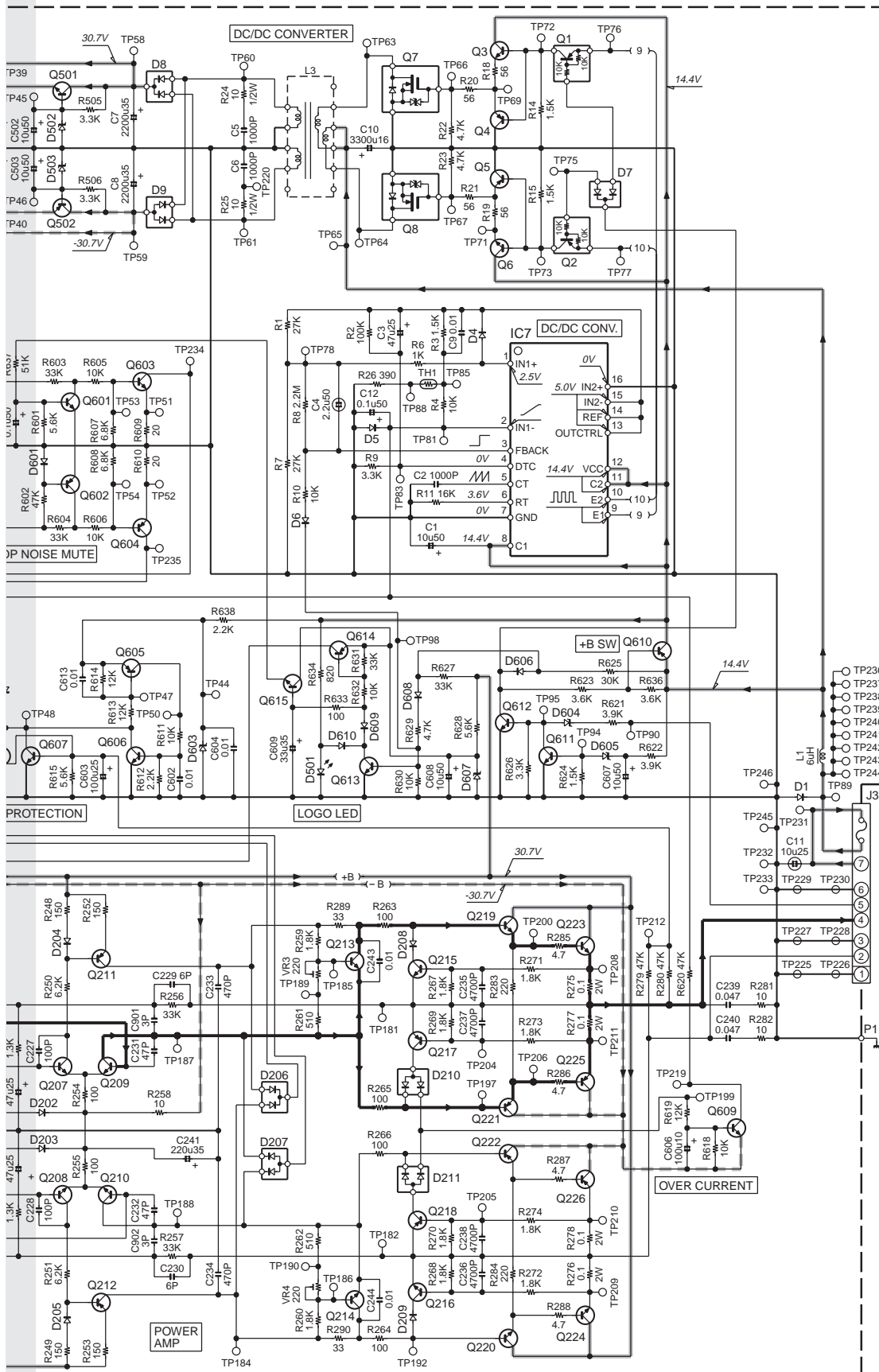

2SA817A-F
 2SA992-A
 2SC1627A-F
 2SC1845-A

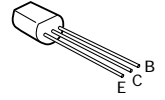

2SA1576A



2SC3419

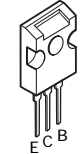

2SB1375-F
 2SD2012-F

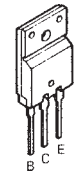

2SC4081

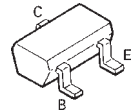

DTA114EUA

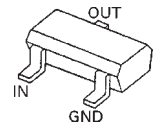

CAUTION : For continued safety, replace safety critical components only with manufacturer's recommended parts (refer to parts list).

⚠ Indicates safety critical components. To reduce the risk of electric shock, leakage-current or resistance measurements shall be carried out (exposed parts are acceptably insulated from the supply circuit) before the appliance is returned to the customer.

- DC voltages are as measured with a high impedance voltmeter. Values may vary slightly due to variations between individual instruments or/and units.

KAC-6202

KAC-6202

EXPLODED VIEW

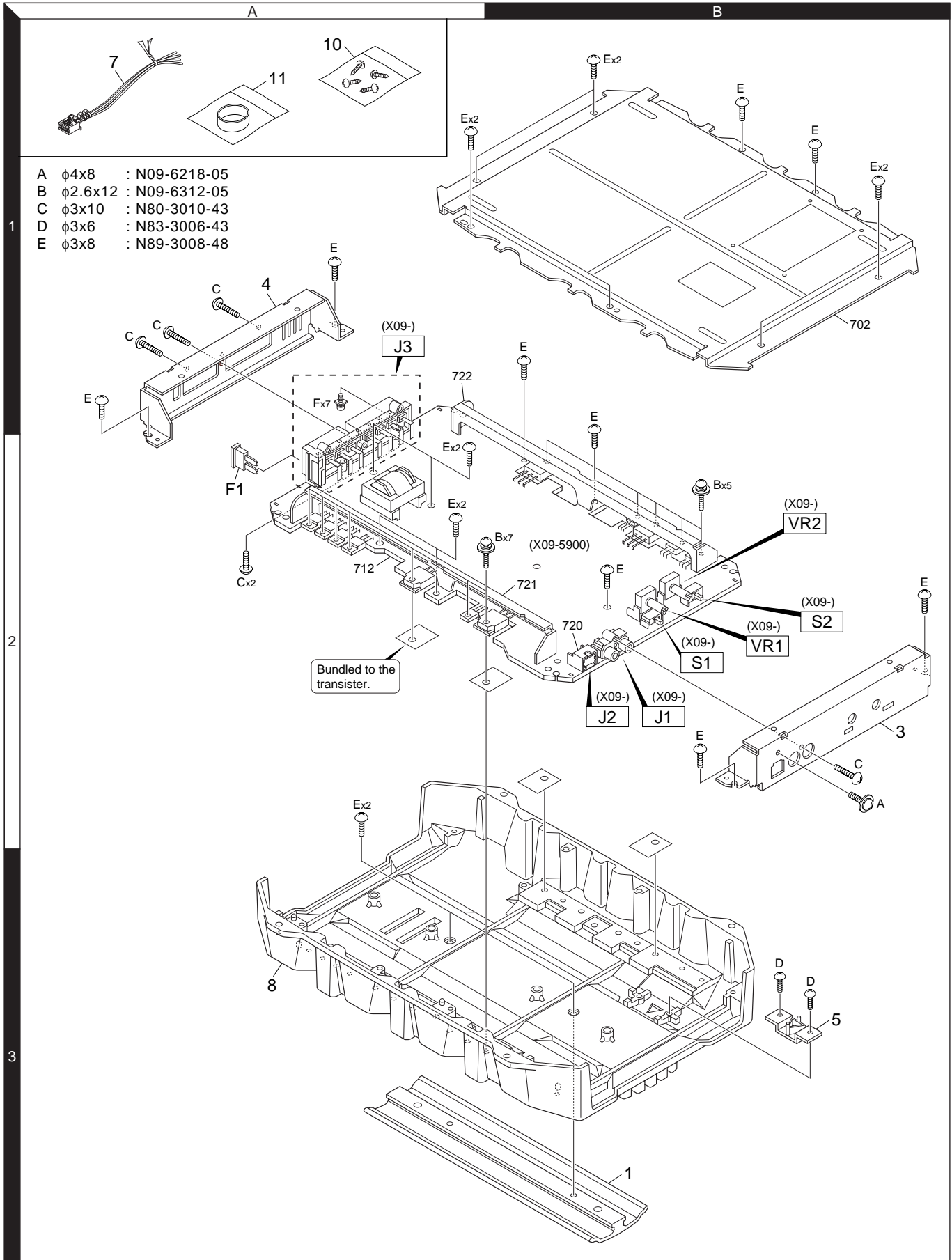

PARTS LIST

* New parts

Parts without **Parts No.** are not supplied.

Les articles non mentionnés dans le **Parts No.** ne sont pas fournis.

Teile ohne **Parts No.** werden nicht geliefert.

Ref. No.	Add	New	Parts No.	Description	Destination
KAC-6202					
1	3B	*	A21-4487-02	DRESSING PANEL	K
1	3B	*	A21-4541-02	DRESSING PANEL	E1M1
3	2B	*	A64-3554-02	PANEL	
4	1A	*	A84-0385-02	REAR PANEL	
5	3B		B19-2324-03	LIGHTING BOARD	
-			B46-0100-50	WARRANTY CARD	
-		*	B64-3041-00	INSTRUCTION MANUAL (ENG.FRE.SPA.)	KE1
-		*	B64-3042-00	INSTR.MANUAL (GER.DUT.ITA.POR.)	E1
-		*	B64-3043-00	INSTRUCTION MANUAL (ENG.T-CHI.)	M1
7	1A		E30-6145-05	CONNECTING CORD ASSY	
8	3A	*	F01-1783-01	HEAT SINK	
△ F1	2A		F52-0014-05	FUSE (BLADE TYPE) 25A	
-		*	H10-4939-13	POLYSTYRENE FOAMED FIXTURE	
-			H25-1192-04	PROTECTION BAG (370X440)	
-			H25-1200-04	PROTECTION BAG (250X350X0.03)	
-		*	H54-3446-03	ITEM CARTON CASE	K
-		*	H54-3447-03	ITEM CARTON CASE	M1
-		*	H54-3500-03	ITEM CARTON CASE	E1
10	1A		N99-1587-05	SCREW SET	
A	2B		N09-6218-05	TAPTITE SCREW (4X8)	
B	2B	*	N09-6312-05	SEMS (TAPTITE SCREW) (2.6X12)	
C	1A		N80-3010-43	PAN HEAD TAPTITE SCREW	
D	3B		N83-3006-43	PAN HEAD TAPTITE SCREW	
E	1B		N89-3008-48	BINDING HEAD TAPTITE SCREW	
F	1A		N09-4215-08	SEMS 4M-NI	
11	1A		W01-1607-05	ACCESSORIES	
AUDIO UNIT (X09-5900-10)					
D501			B30-1601-05	LED	
C1			CD04BJ1H100M	ELECTRO 10UF 50WV	
C2			CK45FB1H102K	CERAMIC 1000PF K	
C3			CD04BJ1E470M	ELECTRO 47UF 25WV	
C4			C90-5563-05	ELECTRO 2.2UF 50WV	
C5,6			CK45FB1H102K	CERAMIC 1000PF K	
C7,8			CD04AZ1V222M	ELECTRO 2200UF 35WV	
C9			CK73GB1H103K	CHIP C 0.010UF K	
C10		*	CD04AY1C332M	ELECTRO 3300UF 16WV	
C11			C90-5557-05	ELECTRO 10UF 25WV	
C12			CD04BJ1H0R1M	ELECTRO 0.1UF 50WV	
C101,102			CK73GB1H102K	CHIP C 1000PF K	
C103,104			CD04BJ1H100M	ELECTRO 10UF 50WV	
C105,106			CC73GCH1H150J	CHIP C 15PF J	
C107,108			CK73GB1H103K	CHIP C 0.010UF K	
C109,110			CC73GCH1H150J	CHIP C 15PF J	
C111,112			CD04BJ1E470M	ELECTRO 47UF 25WV	
C113-116			CD04AS1V100M	ELECTRO 10UF 35WV	
C117			CK45FB1H102K	CERAMIC 1000PF K	
C118			CK73FB1H104K	CHIP C 0.10UF K	
C119-122			CC73GCH1H101J	CHIP C 100PF J	
C203,204			CK73GB1H103K	CHIP C 0.010UF K	

Ref. No.	Add	New	Parts No.	Description	Destination
C205,206			CD04BJ1H100M	ELECTRO 10UF 50WV	
C207,208			CK73GB1H473K	CHIP C 0.047UF K	
C209,210			CK73FB1H334K	CHIP C 0.33UF K	
C211,212			CK73GB1H103K	CHIP C 0.010UF K	
C213-216			CD04AS1V100M	ELECTRO 10UF 35WV	
C219,220			CD04BJ1H100M	ELECTRO 10UF 50WV	
C221,222			CC73GCH1H471J	CHIP C 470PF J	
C223,224			CK73GB1H472K	CHIP C 4700PF K	
C225,226			CD04BJ1E470M	ELECTRO 47UF 25WV	
C227,228			CC73GCH1H101J	CHIP C 100PF J	
C229,230			CC73GCH1H060D	CHIP C 6.0PF D	
C231,232			CC45FCH1H470J	CERAMIC 47PF J	
C233,234			CC45FSL1H471J	CERAMIC 470PF J	
C235-238			CK45FB1H472K	CERAMIC 4700PF K	
C239,240			CQ92FM1H473J	MYLAR 0.047UF J	
C241		*	CD04BJ1V221M	ELECTRO 220UF 35WV	
C242			CC73GCH1H470J	CHIP C 47PF J	
C243,244			CK73GB1H103K	CHIP C 0.010UF K	
C245-247			CC73GCH1H470J	CHIP C 47PF J	
C502,503			CD04BJ1H100M	ELECTRO 10UF 50WV	
C504,505			CD04BJ1E470M	ELECTRO 47UF 25WV	
C601			CD04BJ1H0R1M	ELECTRO 0.1UF 50WV	
C602			CK73GB1H103K	CHIP C 0.010UF K	
C603			CD04BJ1E101M	ELECTRO 100UF 25WV	
C604			CK73GB1H103K	CHIP C 0.010UF K	
C605			CD04BJ1H4R7M	ELECTRO 4.7UF 50WV	
C606			CD04BJ1A101M	ELECTRO 100UF 10WV	
C607,608			CD04BJ1H100M	ELECTRO 10UF 50WV	
C609			CD04BJ1V330M	ELECTRO 33UF 35WV	
C611,612			CD04BJ1H470M	ELECTRO 47UF 50WV	
C613			CK73GB1H103K	CHIP C 0.010UF K	
C901,902			CC73GCH1H030C	CHIP C 3.0PF C	
J1		*	E63-0925-05	PIN JACK	
J2			E58-1031-05	RECTANGULAR RECEPTACLE	
△ J3			E70-0830-25	SCREW TERMINAL BOARD	
L1			L33-1920-05	CHOKE COIL	
L3		*	L19-0776-05	TRANSFORMER FOR CONVERTER	
C	2A		N80-3010-43	PAN HEAD TAPTITE SCREW	
R1			RK73GB2A273J	CHIP R 27K J 1/10W	
R2			RK73GB2A104J	CHIP R 100K J 1/10W	
R3			RK73GB2A152J	CHIP R 1.5K J 1/10W	
R4			RK73GB2A103J	CHIP R 10K J 1/10W	
R6			RK73GB2A102J	CHIP R 1.0K J 1/10W	
R7			RK73GB2A273J	CHIP R 27K J 1/10W	
R8			RK73GB2A225J	CHIP R 2.2M J 1/10W	
R9			RK73GB2A332J	CHIP R 3.3K J 1/10W	
R10			RK73GB2A103J	CHIP R 10K J 1/10W	
R11			RK73GB2A163J	CHIP R 16K J 1/10W	
R14,15			RK73GB2A152J	CHIP R 1.5K J 1/10W	
R18-21			RK73GB2A560J	CHIP R 56 J 1/10W	
R22,23			RK73GB2A472J	CHIP R 4.7K J 1/10W	
R24,25			RD14DB2H100J	SMALL-RD 10 J 1/2W	
R26			RK73GB2A391J	CHIP R 390 J 1/10W	

E1 : Europe K : North America M1 : Other Areas

△ Indicates safety critical components.

KAC-6202

PARTS LIST

AUDIO UNIT (X09-5900-10)

Ref. No.	A d d	N e w	Parts No.	Description	Desti- nation
R101,102			RD14BB2C102J	RD 1.0K J 1/6W	
R103-108			RK73GB2A103J	CHIP R 10K J 1/10W	
R109-112			RN73GH1J103D	CHIP R 10K D 1/16W	
R113,114			RK73GB2A102J	CHIP R 1.0K J 1/10W	
R117-120			RN73GH1J103D	CHIP R 10K D 1/16W	
R121			RK73GB2A473J	CHIP R 47K J 1/10W	
R125,126			RK73GB2A431J	CHIP R 430 J 1/10W	
R127-130			RK73GB2A563J	CHIP R 56K J 1/10W	
R131,132			RD14BB2C222J	RD 2.2K J 1/6W	
R133			RD14BB2E102J	RD 1.0K J 1/4W	
R134-137			RD14BB2C473J	RD 47K J 1/6W	
R138			RK73GB2A100J	CHIP R 10 J 1/10W	
R201,202			RK73GB2A103J	CHIP R 10K J 1/10W	
R203			RK73GB2A203J	CHIP R 20K J 1/10W	
R204,205			RK73GB2A103J	CHIP R 10K J 1/10W	
R206,207			RK73GB2A203J	CHIP R 20K J 1/10W	
R208,209			RK73GB2A103J	CHIP R 10K J 1/10W	
R210,211			RK73GB2A222J	CHIP R 2.2K J 1/10W	
R212,213			RK73GB2A103J	CHIP R 10K J 1/10W	
R214,215			RK73GB2A302J	CHIP R 3.0K J 1/10W	
R216,217			RK73GB2A163J	CHIP R 16K J 1/10W	
R218,219			RK73GB2A101J	CHIP R 100 J 1/10W	
R220,221			RK73GB2A472J	CHIP R 4.7K J 1/10W	
R222,223			RK73GB2A473J	CHIP R 47K J 1/10W	
R224,225			RK73GB2A472J	CHIP R 4.7K J 1/10W	
R226,227			RK73GB2A473J	CHIP R 47K J 1/10W	
R228,229			RK73GB2A222J	CHIP R 2.2K J 1/10W	
R230,231			RK73GB2A103J	CHIP R 10K J 1/10W	
R232,233			RK73GB2A222J	CHIP R 2.2K J 1/10W	
R234,235			RK73GB2A104J	CHIP R 100K J 1/10W	
R236,237			RK73GB2A333J	CHIP R 33K J 1/10W	
R238,239			RK73GB2A822J	CHIP R 8.2K J 1/10W	
R240,241			RK73GB2A821J	CHIP R 820 J 1/10W	
R242,243			RK73GB2A101J	CHIP R 100 J 1/10W	
R244,245			RK73GB2A821J	CHIP R 820 J 1/10W	
R246,247			RK73GB2A132J	CHIP R 1.3K J 1/10W	
R248,249			RK73GB2A151J	CHIP R 150 J 1/10W	
R250,251		*	RK73FB2B622J	CHIP R 6.2K J 1/8W	
R252,253			RK73GB2A151J	CHIP R 150 J 1/10W	
R254,255			RK73GB2A101J	CHIP R 100 J 1/10W	
R256,257			RD14BB2E333J	RD 33K J 1/4W	
R258			RD14NB2E100J	RD 10 J 1/4W	
R259,260			RK73GB2A182J	CHIP R 1.8K J 1/10W	
R261,262			RK73GB2A511J	CHIP R 510 J 1/10W	
R263-266			RK73FB2B101J	CHIP R 100 J 1/8W	
R267-274			RK73GB2A182J	CHIP R 1.8K J 1/10W	
R275-278			R92-0205-05	METAL-PLATE 0.1 K 2W	
R279,280			RK73GB2A473J	CHIP R 47K J 1/10W	
R281,282			RD14BB2E100J	RD 10 J 1/4W	
R283,284			RK73FB2B221J	CHIP R 220 J 1/8W	
R285-288			RD14NB2E4R7J	RD 4.7 J 1/4W	
R289,290			RK73GB2A330J	CHIP R 33 J 1/10W	
R291,292			RK73GB2A103J	CHIP R 10K J 1/10W	
R505,506			RD14BB2C332J	RD 3.3K J 1/6W	
R601			RK73GB2A562J	CHIP R 5.6K J 1/10W	

Ref. No.	A d d	N e w	Parts No.	Description	Desti- nation
R602			RK73GB2A473J	CHIP R 47K J 1/10W	
R603,604			RK73GB2A333J	CHIP R 33K J 1/10W	
R605,606			RK73GB2A103J	CHIP R 10K J 1/10W	
R607,608			RK73GB2A682J	CHIP R 6.8K J 1/10W	
R609,610			RK73GB2A200J	CHIP R 20 J 1/10W	
R611			RK73GB2A103J	CHIP R 10K J 1/10W	
R612			RK73GB2A222J	CHIP R 2.2K J 1/10W	
R613,614			RK73GB2A123J	CHIP R 12K J 1/10W	
R615			RK73GB2A562J	CHIP R 5.6K J 1/10W	
R616			RK73GB2A104J	CHIP R 100K J 1/10W	
R617			RK73GB2A154J	CHIP R 150K J 1/10W	
R618			RK73GB2A103J	CHIP R 10K J 1/10W	
R619			RK73GB2A123J	CHIP R 12K J 1/10W	
R620			RK73GB2A473J	CHIP R 47K J 1/10W	
R621,622			RD14BB2C392J	RD 3.9K J 1/6W	
R623			RK73GB2A362J	CHIP R 3.6K J 1/10W	
R624			RK73GB2A152J	CHIP R 1.5K J 1/10W	
R625			RK73GB2A303J	CHIP R 30K J 1/10W	
R626			RK73GB2A332J	CHIP R 3.3K J 1/10W	
R627			RK73GB2A333J	CHIP R 33K J 1/10W	
R628			RK73FB2B562J	CHIP R 5.6K J 1/8W	
R629			RK73GB2A472J	CHIP R 4.7K J 1/10W	
R630			RK73GB2A103J	CHIP R 10K J 1/10W	
R631			RK73GB2A333J	CHIP R 33K J 1/10W	
R632			RK73GB2A103J	CHIP R 10K J 1/10W	
R633			RD14BB2C101J	RD 100 J 1/6W	
R634			RD14BB2E821J	RD 820 J 1/4W	
R636			RK73GB2A362J	CHIP R 3.6K J 1/10W	
R637			RK73GB2A513J	CHIP R 51K J 1/10W	
R638			RD14BB2C222J	RD 2.2K J 1/6W	
VR1		*	R31-0232-15	VARIABLE RESISTOR	
VR2		*	R31-0215-15	VARIABLE RESISTOR	
VR3,4		*	R32-0116-05	SEMI FIXED VARIABLE RESISTOR	
W300			R92-2053-05	CHIP R 0 OHM J 1/8W	
W301			R92-1252-05	CHIP R 0 OHM J 1/16W	
W302			R92-2053-05	CHIP R 0 OHM J 1/8W	
W303,304			R92-1252-05	CHIP R 0 OHM J 1/16W	
W305			R92-2053-05	CHIP R 0 OHM J 1/8W	
W306			R92-1252-05	CHIP R 0 OHM J 1/16W	
W307			R92-2053-05	CHIP R 0 OHM J 1/8W	
W308,309			R92-1252-05	CHIP R 0 OHM J 1/16W	
W310,311			R92-2053-05	CHIP R 0 OHM J 1/8W	
W312			R92-1252-05	CHIP R 0 OHM J 1/16W	
W313			R92-2053-05	CHIP R 0 OHM J 1/8W	
W314			R92-1252-05	CHIP R 0 OHM J 1/16W	
W315-317			R92-2053-05	CHIP R 0 OHM J 1/8W	
W318-320			R92-1252-05	CHIP R 0 OHM J 1/16W	
W321,322			R92-2053-05	CHIP R 0 OHM J 1/8W	
W323-325			R92-1252-05	CHIP R 0 OHM J 1/16W	
W326-328			R92-2053-05	CHIP R 0 OHM J 1/8W	
W329			R92-1252-05	CHIP R 0 OHM J 1/16W	
W330-332			R92-2053-05	CHIP R 0 OHM J 1/8W	
W333,334			R92-1252-05	CHIP R 0 OHM J 1/16W	
W335,336			R92-2053-05	CHIP R 0 OHM J 1/8W	
W337-339			R92-1252-05	CHIP R 0 OHM J 1/16W	

E1 : Europe K : North America M1 : Other Areas

△ Indicates safety critical components.

PARTS LIST

AUDIO UNIT (X09-5900-10)

Ref. No.	Add	New	Parts No.	Description	Destination	Ref. No.	Add	New	Parts No.	Description	Destination
W340			R92-2053-05	CHIP R 0 OHM J 1/8W		D601,602			1SS133	DIODE	
W341			R92-1252-05	CHIP R 0 OHM J 1/16W		D603			02DZ10F-Y	ZENER DIODE	
W342			R92-2053-05	CHIP R 0 OHM J 1/8W		D604			02DZ6.8F-Y	ZENER DIODE	
W343-347			R92-1252-05	CHIP R 0 OHM J 1/16W		D605			02DZ15F-Y	ZENER DIODE	
W348			R92-2053-05	CHIP R 0 OHM J 1/8W		D606			1SS133	DIODE	
W349-351			R92-1252-05	CHIP R 0 OHM J 1/16W		D607			02DZ10F-Y	ZENER DIODE	
W352,353			R92-2053-05	CHIP R 0 OHM J 1/8W		D608-612			1SS133	DIODE	
W354			R92-1252-05	CHIP R 0 OHM J 1/16W		IC1-6			RC4580IDR	ANALOGUE IC	
W355,356			R92-2053-05	CHIP R 0 OHM J 1/8W		IC7			TL494IDR	ANALOGUE IC	
W357,358			R92-1252-05	CHIP R 0 OHM J 1/16W		Q1,2			DTA114EUA	DIGITAL TRANSISTOR	
W359-366			R92-2053-05	CHIP R 0 OHM J 1/8W		Q3			2SC4097	TRANSISTOR	
W367,368			R92-1252-05	CHIP R 0 OHM J 1/16W		Q4,5			2SA1577	TRANSISTOR	
W369,370			R92-2053-05	CHIP R 0 OHM J 1/8W		Q6			2SC4097	TRANSISTOR	
W371			R92-1252-05	CHIP R 0 OHM J 1/16W		Q7,8			2SK3662-F	FET	
W372,373			R92-2053-05	CHIP R 0 OHM J 1/8W		Q201,202			2SC4081	TRANSISTOR	
W374,375			R92-1252-05	CHIP R 0 OHM J 1/16W		Q203-206			2SA1576A(R,S)	TRANSISTOR	
W376			R92-2053-05	CHIP R 0 OHM J 1/8W		Q207-210			2SC1845-A(F,E)	TRANSISTOR	
W377,378			R92-1252-05	CHIP R 0 OHM J 1/16W		Q211,212			2SA992-A(F,E)	TRANSISTOR	
W379-385			R92-2053-05	CHIP R 0 OHM J 1/8W		Q213,214			2SC3419(Y)-F	TRANSISTOR	
W386			R92-1252-05	CHIP R 0 OHM J 1/16W		Q215,216			2SC1845-A(F,E)	TRANSISTOR	
W387			R92-2053-05	CHIP R 0 OHM J 1/8W		Q217,218			2SA992-A(F,E)	TRANSISTOR	
W388			R92-1252-05	CHIP R 0 OHM J 1/16W		Q219,220			2SC1627A-F	TRANSISTOR	
W389-391			R92-2053-05	CHIP R 0 OHM J 1/8W		Q221,222			2SA817A-F	TRANSISTOR	
W392			R92-1252-05	CHIP R 0 OHM J 1/16W		Q223,224			2SC3856NF	TRANSISTOR	
W393-398			R92-2053-05	CHIP R 0 OHM J 1/8W		Q225,226			2SA1492NF	TRANSISTOR	
W399			R92-1252-05	CHIP R 0 OHM J 1/16W		Q501			2SD2012-F	TRANSISTOR	
W400			R92-2053-05	CHIP R 0 OHM J 1/8W		Q502			2SB1375-F	TRANSISTOR	
W401,402			R92-1252-05	CHIP R 0 OHM J 1/16W		Q601			2SC4081	TRANSISTOR	
W403			R92-2053-05	CHIP R 0 OHM J 1/8W		Q602			2SA1576A(R,S)	TRANSISTOR	
W404-408			R92-1252-05	CHIP R 0 OHM J 1/16W		Q603			2SC4081	TRANSISTOR	
W409			R92-2053-05	CHIP R 0 OHM J 1/8W		Q604,605			2SA1576A(R,S)	TRANSISTOR	
W410			R92-1252-05	CHIP R 0 OHM J 1/16W		Q606-609			2SC4081	TRANSISTOR	
W411			R92-2053-05	CHIP R 0 OHM J 1/8W		Q610			2SB1241	TRANSISTOR	
W412-418			R92-1252-05	CHIP R 0 OHM J 1/16W		Q611-613			2SC4081	TRANSISTOR	
W419			R92-2053-05	CHIP R 0 OHM J 1/8W		Q614			2SA1576A(R,S)	TRANSISTOR	
W420-422			R92-1252-05	CHIP R 0 OHM J 1/16W		Q615			2SC1845-A(F,E)	TRANSISTOR	
S1			S62-0842-05	SLIDE SWITCH		TH1			NT732ATTD103J	THERMISTOR	
S2			S31-2630-05	SLIDE SWITCH							
D1			RM4ZLF-J4NF	DIODE							
D4-6			1SS133	DIODE							
D7			LM1MA142WK-G	DIODE							
D8			FCH10A20	DIODE							
D9			FRH10A20	DIODE							
D101			LM1MA142WA-G	DIODE							
D102			LM1MA142WK-G	DIODE							
D103			UMZ6.8N	ZENER DIODE							
D201			LM1MA142WA-G	DIODE							
D202-205			1SS133	DIODE							
D206			LM1MA142WK-G	DIODE							
D207			LM1MA142WA-G	DIODE							
D208,209			1SS133	DIODE							
D210,211			LM1MA142WA-G	DIODE							
D502,503			02DZ16F-Y	ZENER DIODE							

E1 : Europe K : North America M1 : Other Areas

△ Indicates safety critical components.

KAC-6202

SPECIFICATIONS

Audio Section

Max Power Output	400W
Rated Power Output	
Normal (4 Ω) (20Hz~20kHz, 0.08% THD)	60W x 2
Normal (4 Ω) (DIN : 45324 , +B=14.4V)	60W x 2
Normal (2 Ω) (1kHz, 0.8% THD)	100W x 2
Bridged (4 Ω) (1kHz, 0.8% THD)	200W x 1
Frequency Response (+0, -3dB)	10Hz~45kHz
Sensitivity (rated output)	
MAX.	0.2V
MIN.	5.0V
Signal to Noise Ratio	100dB
Input Impedance	10k Ω
Low Pass Filter Frequency (12dB/oct.)	50~200Hz (variable)
High Pass Filter Frequency (12dB/oct.)	50~200Hz (variable)

General

Operating Voltage	14.4V (11~16V allowable)
Current Consumption	25A
Dimensions (W x H x D)	330 x 59 x 242 mm (13 x 2-5/16 x 9-8/16 inch)
Weight	2.8kg (6.2 lbs)

CEA-2006

RMS Watts per channel @ 4 Ω < 1% THD+N	60W x 2
RMS Watts per channel @ 2 Ω < 1% THD+N	100W x 2

KENWOOD follows a policy of continuous advancements in development.
For this reason specifications may be changed without notice.

Installation

